



CAVITY FIRE BARRIERS

THE PRODUCT RANGE

Technical Specification

CAVITY FIRE BARRIERS

Product	Specification Integrity & Insulation		Length /Pack	Width /Pack	Total Pack	Thick (mm)	Weight kg/m ²	Acoustic Rating	Vertical Use	Horizontal Use	Staple Gun R31 or B16		Staples R31 or B16		Selling Price
											Yes	Yes			
VULCAN 536900	60 mins	20 mins	6m	1.3m	7.8m ²	6.5	1.8	-	Yes	No	Yes	Yes	12mm	12mm	
PLUS 30 536901	30 mins	30 mins	6m	1.3m	7.8m ²	10	2.2	16db	Yes	Yes	Yes	Yes	12mm	12mm	
PLUS 60 536902	60 mins	30 mins	6m	1.3m	7.8m ²	10	2.2	16db	Yes	Yes	Yes	Yes	12mm	12mm	
TITAN 536903	60 mins	60 mins	6m	1.3m	7.8m ²	15	3.9	20db	Yes	No	No	Yes	No	8mm & 16mm	

FIRE & SMOKE BARRIERS

Product	Specification Integrity & Insulation		Length /Pack	Width /Pack	Total Pack	Thick (mm)	Weight kg/m ²	Acoustic Rating	Vertical Use	Horizontal Use	Staple Gun R31 or B16		Staples R31 or B16		Selling Price
											Yes	Yes			
PHOENIX 536895	113 mins	-	25m	1.3m	32.5m ²	0.4	400g	-	Yes	No	Yes	Yes	8mm	8mm	
PHOENIX 536896	113 mins	-	10m	1.3m	13m ²	0.4	400g	-	Yes	No	Yes	Yes	8mm	8mm	
FLY 2 536897	120 mins	-	25m	1.0m	25m ²	1.3	900g	13db	Yes	Yes	Yes	Yes	12mm	12mm	

Staple Guns and Staples

R31 Staple Gun	554988	PHOENIX/VULCAN/PLUS
R31 8mm SS Staples	554990	PHOENIX/VULCAN/PLUS
B31 12mm SS Staples	554991	PHOENIX/VULCAN/PLUS
B16 Staple Gun	536919	TITAN/PLUS
B16 8mm SS Staples	536922	TITAN/PLUS
B16 12mm SS Staples	536923	TITAN/PLUS
B16 16mm SS Staples	536924	TITAN/PLUS

Accessories

Collaroll x 10 metres	536916
High Temperature Adhesive	536918
Flat Strap 25 x 0.5mm x 25m Roll	579635
Galv. Angle 25 x 25 x 0.5mm	535353
Track 50mm	535312
Track 72mm	535316

Should you have any queries on product applications/performance or wish to discuss Special Project Pricing - please contact FIREFLY directly on Tel: 01706 758817

Delivering Interior Building Products
Exceeding Customer Expectations

Ceilings • Dry Lining • Insulation • Partitioning • Fire Protection • Screws & Fixings • Lighting • Sundries

CCF

FIREFLY PHOENIX - INSTALLATION DETAILS

TOP FIX - Concrete Soffit / Timber

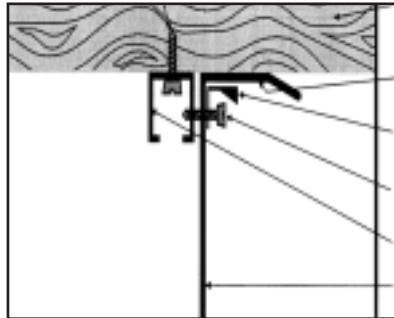

Concrete or Timber Soffit
 Suitable fixings for site Conditions @ 250mm centres
 100mm Overlap
 25mm x 25mm x 0.5mm Galvanised angle
 Suitable self drilling screw
 Galvanised Stud - 50mm
 FIREFLY PHOENIX

NOTE:
 Fix galvanised stud section at 250mm centres
 Cut Phoenix to required length allowing for any penetration management and 100mm fixing overlap at both the top and bottom (see notes on penetration management)
 Fold along the top 100mm overlap and lift into position
 Secure with screws into the stud section
 Align next barrier length as above and seam
 When seamed, fix 25mm x 25mm x 0.5mm galvanised angle onto stud along the barrier to complete the top fix at 250mm centres with a suitable self drilling screw
 All perimeter galvanised angle fittings should be continuous

BOTTOM FIX

Fixing to a Fire Wall

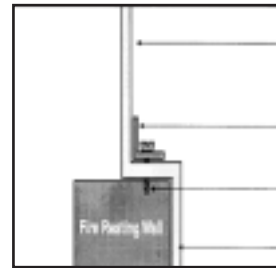

FIREFLY PHOENIX
 25mm x 25mm x 0.5mm Galvanised Angle
 Fixing suitable to the environment @ 250mm centres
 100mm overlap

NOTE
 At the bottom allow a 100mm overlap

Fix using a 25mm x 25mm x 0.5mm galvanised angle secured at 250mm centres.

Fixing to a Suspended Ceiling

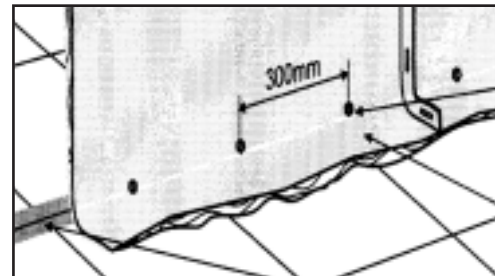

FIREFLY PHOENIX
 Screw
 100mm overlap
 T Section of Ceiling Grid

NOTE
 Use suitable screw fastenings to secure at 300mm centres

Ensures 100mm overlap onto the ceiling grid

SEAMING

Double Fold Method

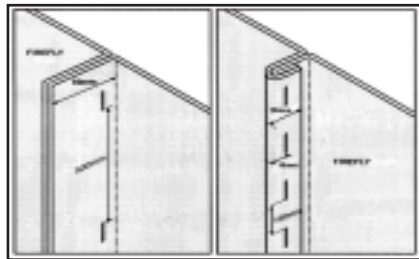

NOTE:
 Bring the two fabrics together and staple at 500mm centres (8mm staples) as Fig. 1.
 The seam is returned back on itself 25mm to give a continuous seal down the joint. A second fix of staples at 100mm centres give the required level of security as Fig. 2.

SIDE FIX

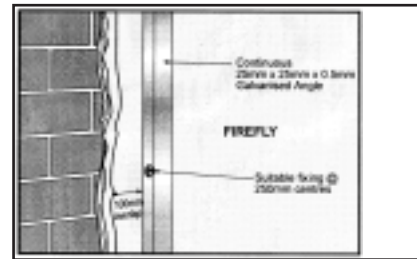

NOTE:
 Ensuring a 100mm overlap, trap FIREFLY PHOENIX using 25mm x 25mm x 0.5mm galvanised angle against the side of the wall using suitable fasteners for site conditions at 250mm centres.
 The galvanised angle must be continuous from the top fix to the bottom fix.

PENETRATION MANAGEMENT / FIREFLY COLLAR

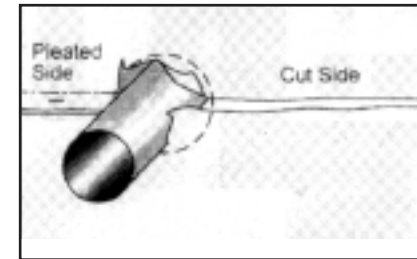

NOTE:
 Cut a slot and feather circle into the barrier, 50mm below the centre line of the penetration. Feed Barrier around penetration.
 Pull the edges of the slot together and seal using the double fold method - as used for the vertical seam.
 Pleat the uncut side by 50mm, stapling at 200mm centres using 8mm staples.

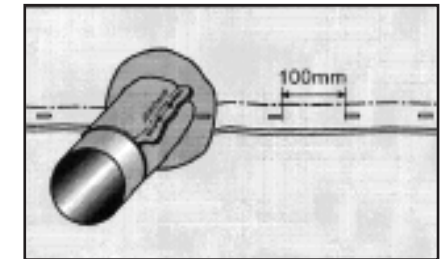

NOTE:
 Wrap the FIREFLY Collar around the penetration and staple (8mm) the edges together tightly at 100mm centres.
 Using 2 x 6mm beads of FLY High Temperature Adhesive attach the flange to the barrier.
 Seal any visible gaps with the Adhesive.
 Staple flange to the pleat and joint using a single staple for each.

NB - FIREFLY Installation details contain patents relevant only to the FIREFLY system and should not be utilised to install other products

Delivering Interior Building Products
 Exceeding Customer Expectations

Ceilings • Dry Lining • Insulation • Partitioning • Fire Protection • Screws & Fixings • Lighting • Sundries

CCF